

Strata Double Heavy Duty Fixed Heads-W9242

Assembly Instructions

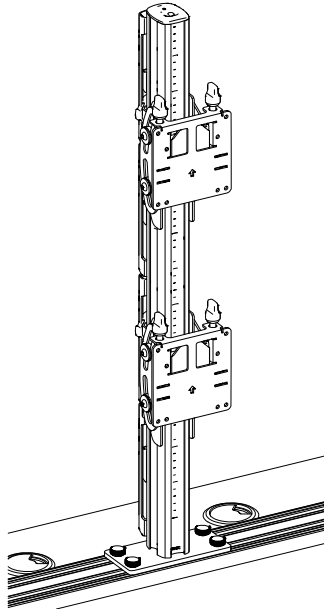

COMPONENT CHECKLIST

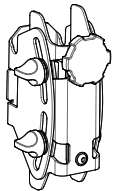

Bracket
(2x)

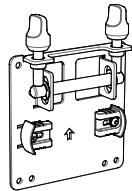

VESA plate
(2x)



Cable Cover



Cable Clip

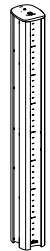

92406 Post
(1x)



10mm Spacer
(8x)

W9242 CONTAINS

- 1x 92406
- 2x 92440
- 1x 92400

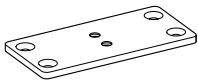

92400 Rail Plate
(1x)



1/4-20 WingNut
1/4-20 Thumb Screw
(4x EA.)

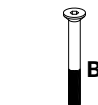

M8x60mm
Screw
(2x)



M4x20mm
Screw
(8x)



M4x10mm
Screw
(8x)

REQUIRED TOOLS

- 8mm Hex Key
- 4mm Hex Key



IMPORTANT INFORMATION

- Please ensure this product is installed as per these installation instructions.
- Do not remove/ throw away the black plastic sleeve on the channel clamp or arm links.
- The manufacturer accepts no responsibility for incorrect installation.
- This product is not suitable for outdoor use or mobile applications.
- Do not over-tighten screws and adjustment points on product.
- This product is not compatible with the Atdec AWM Wall Channel products (including AWM-WS Slat Wall Adaptor, AWM-W6 60 Wall Channel, and AWM-W35 350 Wall Channel).
- VESA mounted accessories (such as mini PC brackets and mounts), offset VESA locations, and unevenly weighted monitors (relative to the center of the VESA mounting interface) exert additional leverage that can exceed the capacity of the mount even though the monitor weight may be within the stated range. Please contact Atdec if you would like further information.

WEIGHT RANGE*

Flat display	0-25kg (55lbs)
Curved display	0-18kg (0-40lbs)

Strata Double Heavy Duty Fixed Heads-W9242

Assembly Instructions

STEP 1 - ATTACH POST TO RAIL PLATE

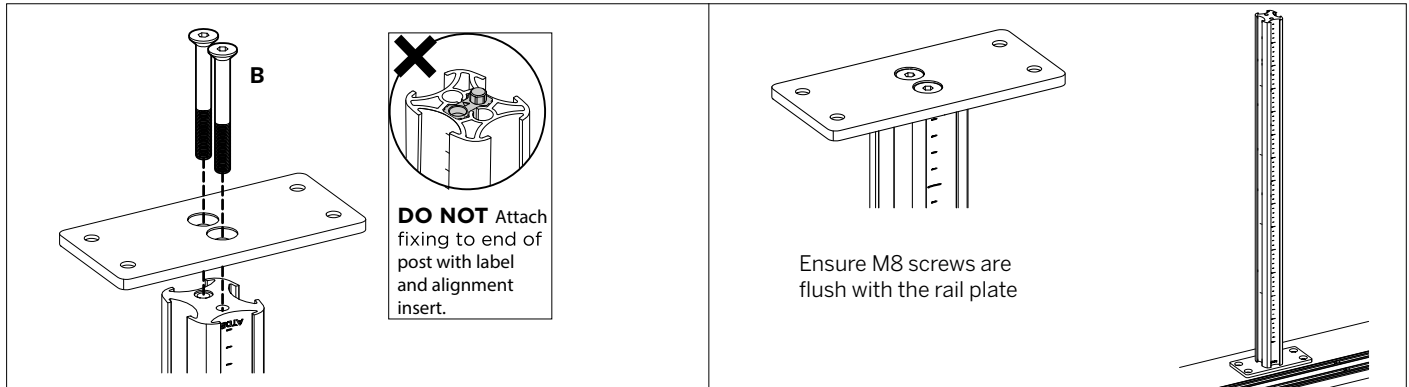

STEP 2 - ATTACH POST TO VERSA TRACK

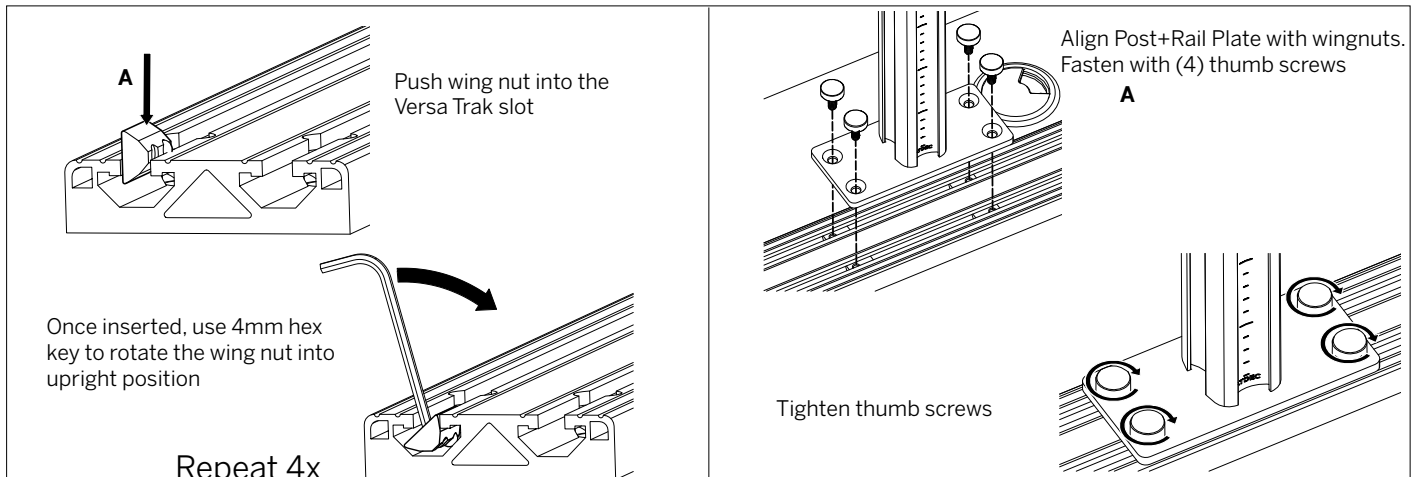

STEP 3 - ATTACH VESA HEADS TO DISPLAYS

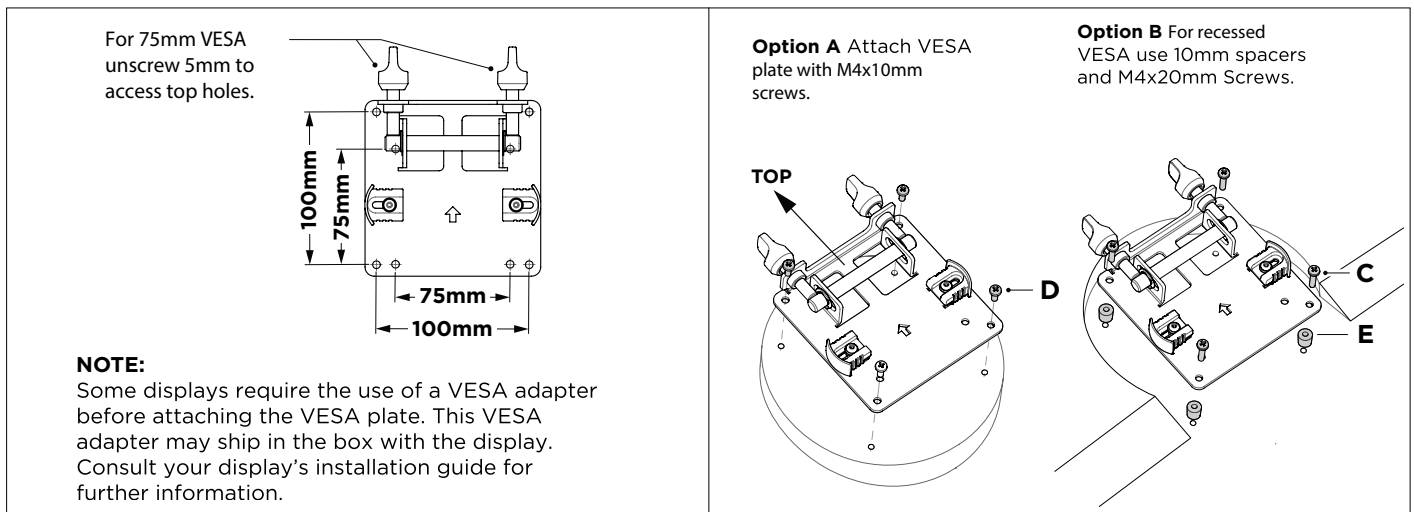

Strata Double Heavy Duty Fixed Heads-W9242

Assembly Instructions

STEP 4 - SLIDE BRACKETS ONTO POST AND SET HEIGHT

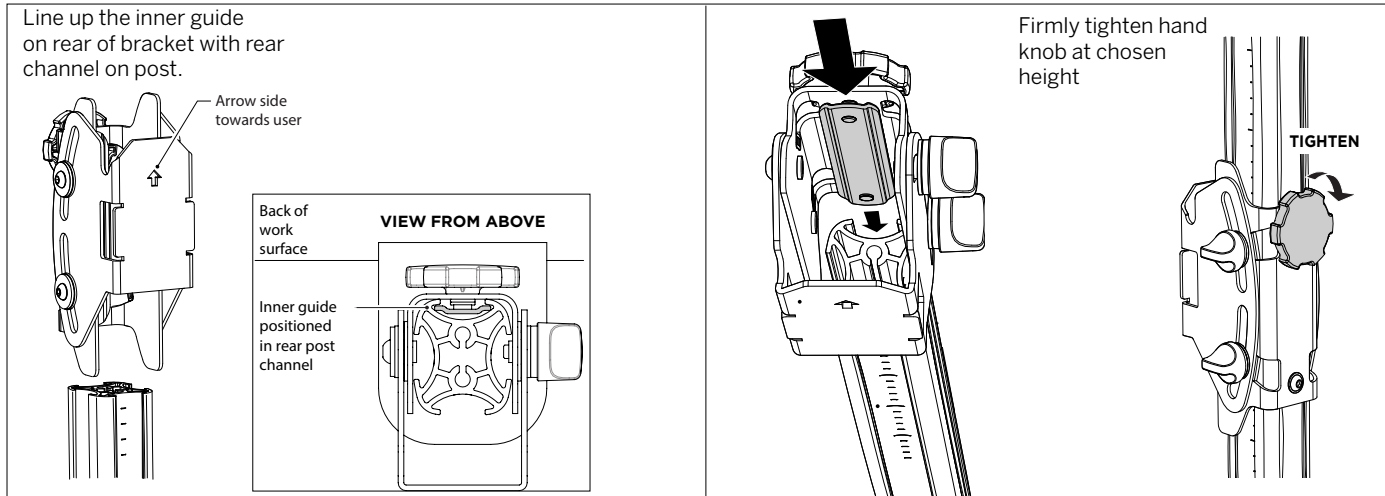

STEP 5 - ATTACH DISPLAYS

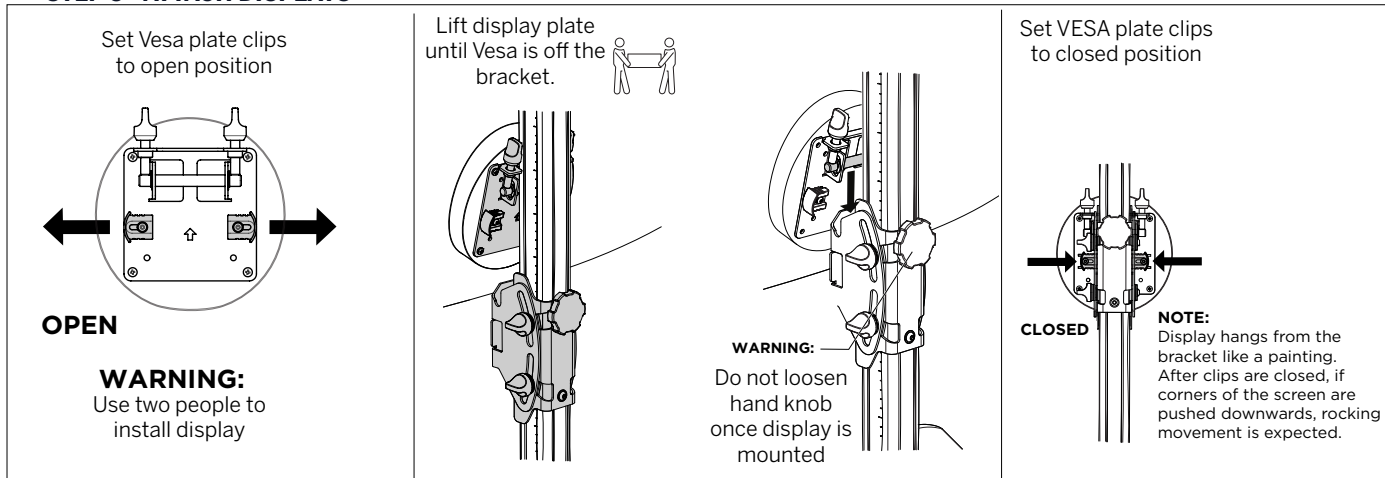

STEP 6 - SET TILT AND FINE ADJUSTMENT

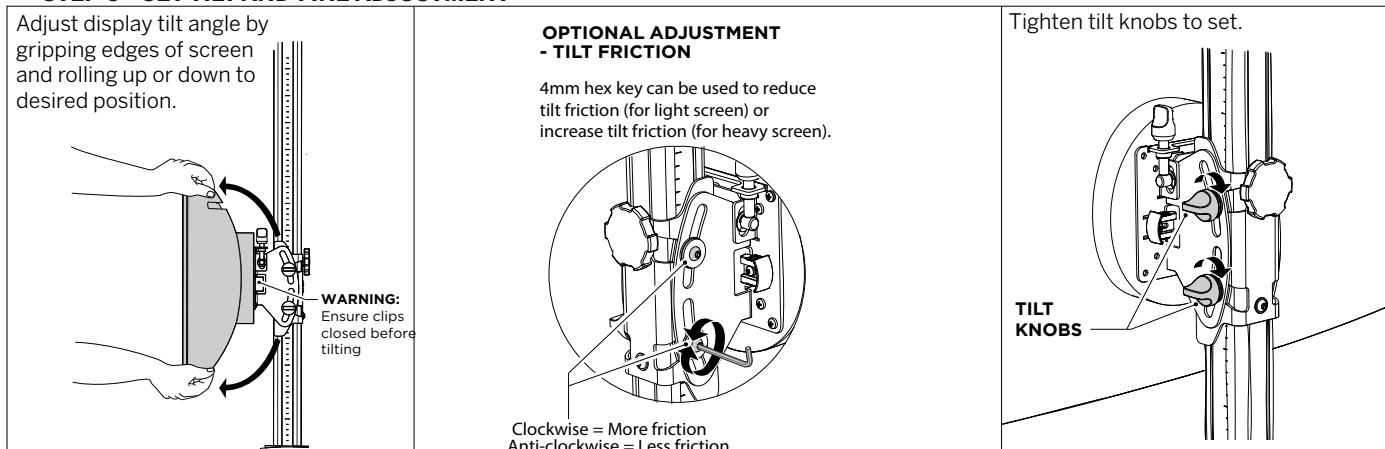

Strata Double Heavy Duty Fixed Heads-W9242

Assembly Instructions

STEP 7 - FINE ADJUSTMENT

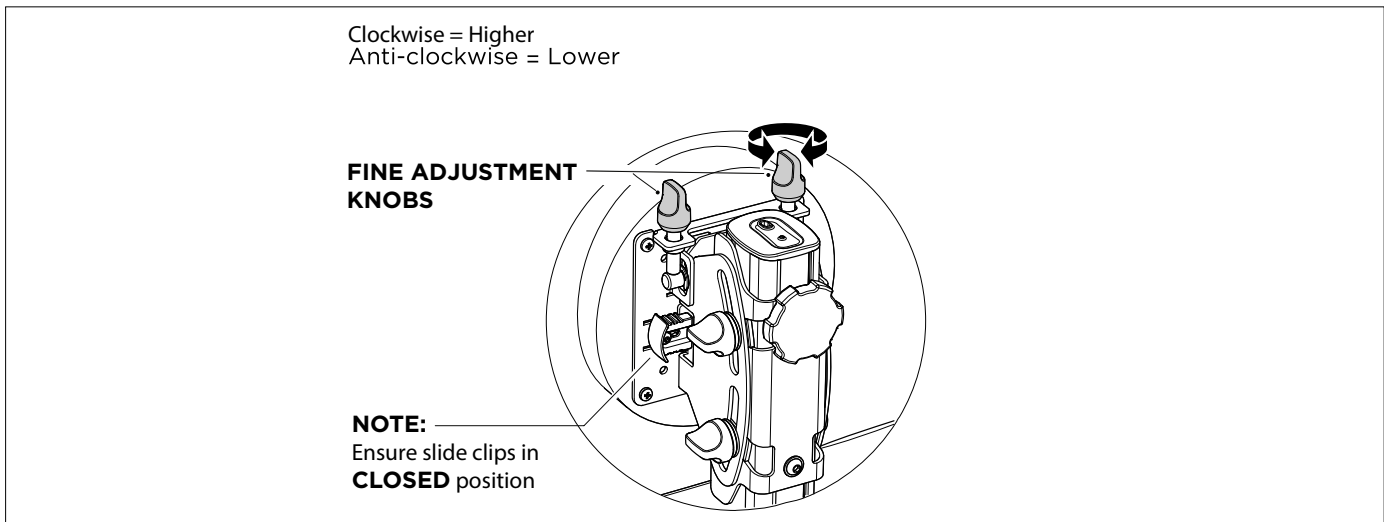

STEP 8 - CABLE MANAGEMENT

